

Paterson Hall

Herrick Archives Number 103

A. IDENTIFICATION & LOCATION

1. Name

1.1 Officially named "Alma W. Paterson Hall" by the Board of Trustees on December 13, 1954. In honor of Alma Wacker Paterson.

1.2 Alternate names noted:

Built under architect's project number 5245. Project included also Bradley (bldg. 097), the addition to Canfield (bldg. 098), and tow additions to the Women's Dinning Hall (bldg. 105). The name of the drawings is "Women's Dormitory--12th Avenue Project." The Paterson portion was designed as the "D Unit." The Lantern (7/20/54) referred to Paterson as "East Hall."

See Addenda Nos. 2,4

The name is sometimes incorrectly spelled "Patterson".

All of the dormitories south of West 12th Avenue are frequently referred to as the "South Dorms".

2. Location

2.1 Located at 191 West 12th Avenue. See map below.

See Addendum No. 1

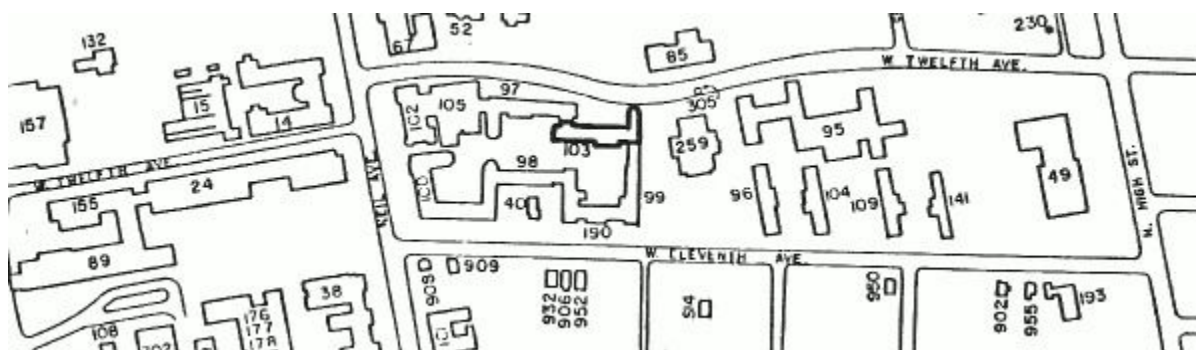

2.2 For greater detail, see Sheet 110 in the book of campus maps in the University Archives.

For identification of other buildings shown, see Appendix A.

3. General Description

3.1 Type of construction:

Reinforced concrete frame with brick exterior

3.2 No. of stories:

Basement and four stories.

3.3 Increments of construction:

None-- entire building constructed at one time.

3.5 Present area of building as shown in inventory records of Division of Campus Planning:

61,420 sq. ft. gross;
42,729 sq. ft. net assignable

See Addendum No. 3

The architect's drawings include in Paterson half of the connecting link between Bradley (B1dg. 097) and Paterson. Campus Planning records include all of this link in Bradley.

3.5 Volume of building is 832,000 cubic feet (PP), which probably includes half of the link connecting Paterson and Bradley (B1dg. 097).

B. PLANNING & CONSTRUCTION

1. On November 17, 1952 the Board of Trustees approve the plans and related documents prepared by Howard Dwight Smith, University Architect, and authorized the solicitation of bids by contractors.

2. Bids were received on March 19, 1953 (T).

3. On April 20,, 1953 the Board of Trustees awarded contracts to the following contractors:

General: James I. Barnes Construction Co.
Electrical: McCarty Bros. Electric Co. .
Heating and ventilating: Sauer Co. , Inc.
Plumbing: Sauer Co., Inc.
Elevator: Otis Elevator Co.

4. Completion and occupancy:

Completed in December 1954 (L 11/29/ 54) and first occupied in January 1955 (L 1/ 5/ 55).

Dedicated May 7. 1955 (Program in Dean of Women's papers, University Archives).

C. COST

Included in Business Office reports as part of total for "Residence Halls for Women" until 1967-68, at which time Paterson was listed separately with a cost of \$1,070,509.55.

D. MISCELLANEOUS

This building has been used from its opening as a girls' dormitory, except for certain rooms set aside for guest suites for the accommodation of guests of the University. (H)

E. PHOTOGRAPHS

1. In Photoarchives:

X 7636

John H. Herrick

April 14, 1972

ADDENDUM NO. 1

The address of the guest suite was listed in 1959 as 187 W. 12th Avenue.

John H. Herrick
August 8, 1977

ADDENDUM NO. 2

Inspection of old campus maps reveals the following additional name for this building:

Women's Dorm D

John H. Herrick
November 11, 1979

ADDENDUM NO. 3

Campus Planning records now show the following areas for this building:

68,108 sq. ft. gross
41,199 sq. ft. net assignable

John H. Herrick
November 7, 1981

ADDENDUM NO. 4

This building is now carried in Campus Planning records as Alma backer Paterson Hall. The official map remains "Alma W. Paterson Hall".

John H. Herrick
August 26, 1986