

# Botanical Hall

Herrick Archives Number H 114

## A. IDENTIFICATION & LOCATION

### 1. Name

1.1 Officially named "Botanical Hall" by Board of Trustees on March 1, 1892.

1.2 Alternate names noted:

Built as "Horticultural & Agricultural Hall"

Botanical Building

Horticultural Bunding

Part of the building was called the conservatory.

Botany Building

State Department of Health Lab

Botanical Horticultural Hall

Old Botany Building

State Board of Health

State Health Lab

Board of Health Building

See Addendum No. 4, 5

### 2. Location

2.1 Located directly in front of the Faculty Club (028) at 181 South Oval Drive. See map below.

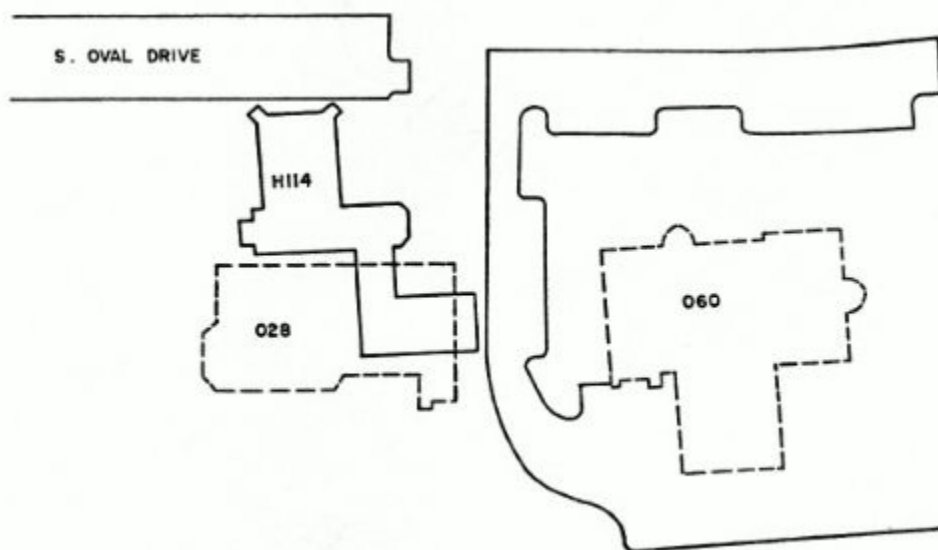

For identification of other buildings shown, see Appendix A.

### 3. General Description

#### 3.1 Type of construction:

Main building had wood interior and brick exterior. (McC 1:8A)

#### 3.2 No. of stories:

Photograph In McCracken (1:66) shows main building included basement, two stories, and attic. Greenhouses were one story.

#### 3.3 Increments of construction:

See Part D

#### 3.4 Size:

3.4.1 McCracken (1:8A) gives 12,076 sq.ft. and 162,300 cu.ft. He indicates that the building contained fourteen rooms.

3.4.2 McCracken's figure appears to be for the main building only. Available maps differ as to the dimensions of the greenhouses, but it would appear that the total greenhouse area was 3,000 sq.ft., or slightly less.

See Addendum No. 3

## B. PLANNING & CONSTRUCTION

1. On April 20, 1883 the Board of Trustees approved the plans and related documents prepared by J.T. Harris and Company and authorized the solicitation of bids by contractors.
2. Bids were received on May 31, 1883 (T).
3. On May 31, 1883 the Board of Trustees awarded contracts to the following contractors:

Excavating: Walter Collins

Painting, glass and glazing: Louis Fink

Stone-masonry: Walter Collins

Carpenter work: C.B. Hall

Cut stone: William Fish and Son

Greenhouse (frames and glass): Lord Manufacturing Company

Brick work: Robert Wood

Steam and hot water heating: Andrew Schwartz

Plastering: Frederick Webber

Gas pipe: F.N. Wilcox

Tin, iron and state: Robert Wood

#### 4. Beginning of work:

The Board of Trustees on June 22, 1883 authorized the president to sign the contracts. Work on the building began during the summer of 1883 (R 1883:23).

#### 5. Completion and occupancy:

The "finishing touches" were given to the building during the summer of 1884 (R 1884:15), and a florist was appointed to take charge of the greenhouse (R 1884:15).

See Addendum No. 2

### C. COST

The original cost was \$15,000 (B).

### D. EXPANSION & DEMOLITION

Details of the expansion and demolition of this building are not clearly documented in most instances. The following sketch and statements summarize the information that has been located.

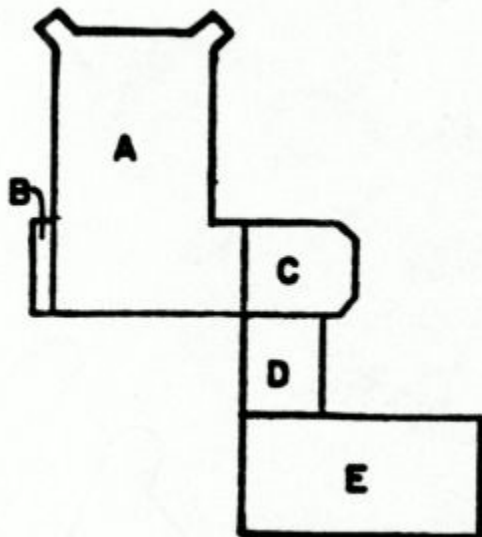

A- Main building (brick)

B- Addition to main building

C- Conservatory, later replaced by one-story brick building

D- Greenhouse (original)

E- Greenhouse addition

1. The sketch shows the building at its maximum size. The original construction, covered in Part B of this report, included A,C, and D.
2. The Board of Trustees on June 16, 1896 reviewed sketches of a small addition to the main building and ordered the improvement made. This addition is designated as "B" in the sketch. The Lantern on September 30, 1896 reported that the addition had been completed. Photograph X 1356 shows the building without Unit B. Photograph X 1821 clearly shows the addition.
3. During the summer of 1896 the size of the greenhouse was more than doubled (L September 16, 1896). Presumably this involved the construction of Unit E.
4. The conservatory (Unit C) was replaced by a one-story brick wing. This is shown in Photograph X 1359 (c 1926) and less clearly in X 2567 (c 1915). The conservatory appears in a 1908 photograph (X 13464). While no record has been found, presumably the greenhouses and conservatory were removed when Botany moved to its new greenhouses (H 225) in 1914). The main building was remodeled for the State Health Department during the summer of 1914 (L September 15, 1914), and the one-story wing replaced the conservatory at that time. The wing housed animals used to supply blood for laboratory use.

See Addendum No. 1

5. Map 191-09 was one of four maps prepared by the University Architect in 1912 and maintained for more than a decade in offices of University Cabinet members. It shows all five units of Building H 114, but with D and E erased. Map 191-15, which was drawn by Bradford some years later, shows the campus in 1913. All five units are included. A 1918 map (191-49) shows only units A,B, and C. These findings are consistent with the hypothesis above that the conservatory and greenhouses were removed when Botany moved to its new quarters in 1914 (Buildings 14 and H 225), and that the conservatory (Unit C) was replaced by a brick structure at that time.
6. The one-story brick wing that replaced the conservatory (Unit C) was demolished as a part of the Faculty Club (028) building project. This demolition was done by George J. Igel and Company, Incorporated (A). The contract for this work was based on bids received on December 5, 1938 and a contract signed on December 22, 1938 (A). The contract specified April 1, 1939 as the completion date; the final estimate was dated May 4, 1939 (A).
7. No record of the demolition of the main building (Units A and B) has been found, but the following findings and hypotheses are pertinent.
  - 7.1 The Board of Health moved from this building to 2535 North High Street, according to a brochure prepared for the dedication of Murray Hall (Building 304). This brochure was written by Leo F. Ey who was chief of the Department of Health Laboratory in 1940. However, some operations remained in Building H 114, as evidenced by the following:
    - 7.1.1 The Faculty Review for March 1941 reports that the announcement was made to Faculty Club members at a meeting on February 25, 1941 or March 4, 1941 that the Board of Health would vacate Building H 114 by April 1.
    - 7.1.2 The Lantern on June 4, 1941 reports that the offices of the Health Lab would move to the North High Street location pending completion of Building 108. The article stated that the equipment had been moved to North High Street earlier.

8. The foregoing would suggest that Building H 114 was demolished after June 4, 1941. The most probable date is the summer of 1941. No Cabinet action has been found authorizing demolition, but no June minutes have been found except for June 2, even though Cabinet normally met at least once a week, and usually more often.

It is possible that demolition occurred later, but the following evidence supports the summer hypothesis:

8.1 The Lantern on October 17, 1941 reported that South Oval Drive was to be widened to make two-way traffic possible. Maps indicate that the roadway was both widened and straightened. Since Building H 114 extended northward to the sidewalk, the building had to be removed before the Street work could start. The authorization for this street work was voted by Cabinet on December 19, 1940, and the delay in starting the work was probably due in part to delay in removing the old building.

8.2 The Lantern on November 14, 1941 carried an article by an unknown student regarding several old buildings, some of which had been demolished and some which were still standing. With respect to Building H 114, the article merely stated that "The Old Botany Building occupied the site of the New Faculty Building." No reference was made to the fact that H 114 had stood in front of the Faculty Club, nor to the fact that it had only recently been demolished. These omissions lead to the hypothesis that the author of the article was new to the campus that quarter, and was not aware that both buildings had only recently occupied the site.

If this hypothesis be true, then H 114 was removed before the opening of the autumn quarter.

9. In conclusion, the most reasonable assumption appears to be that H 114 was demolished after June 4, 1941 and prior to the opening of school in the autumn.

## E. PHOTOGRAPHS

1. In Photoarchives:

X 1352 (shows conservatory)

X 1353

X 1356 - prior to 1896 addition

X 1521

X 1820

X 1821

X 1359 shows addition replacing conservatory

2. Other

McC 1:66

L May 29, 1895

## F. MISCELLANEOUS

The building was turned over to the State Department of Health when Botany moved to the new Botany and Zoology Building (014).

The building was replaced by a new State Health department building on West Tenth Avenue (Building 108).

John H. Herrick  
January 23, 1979

#### ADDENDUM NO. 1

On July 8, 1919, the Board of Trustees authorized the State Board of Health to remove the "glass greenhouse" and to construct in its place a brick addition, in accordance with plans submitted to the Board on that date.

John H. Herrick  
February 15, 1979

#### ADDENDUM NO. 2

The Lantern on October 1, 1884 reported that the Experiment Station Offices had moved into the building. No date is given. This is the type of article in which the Lantern might report changes during the summer, i.e. since the publication of the last issue in the spring.

The article cited also reports that the north wing of the greenhouse had been completed in May. Presumably this is Part D.

John H. Herrick  
February 16, 1979

#### ADDENDUM NO. 3

It appears from the Secretary's annual report for 1883 (R 1883;10) that "D" in the sketch in Part D of this report was a propagating house 25 ft. wide and 40 ft. long. Also, the Secretary reported that the conservatory (Part C in sketch) was 25 ft. wide and 30 ft. long.

John H. Herrick  
February 21, 1979

#### ADDENDUM NO. 4

Inspection of old campus maps reveals the following additional names for this building:

Board of Health Laboratory

Botany Building, First

Botany Building No. 1

Botany Hall

Health Lab

Laboratory, Board of Health

Lab, State Board of Health

Old Botanical Hall

John H. Herrick  
November 10, 1979

**ADDENDUM NO. 5**

The following additional name for this building has been found on old campus maps:

State Board of Health Lab

John H. Herrick  
September 21, 1981