

L-14

L-14

Southern Appalachian White Pine  
Provenance Test

copy 1

need MSFG  
book for  
info,

—done—

S. Appalachian White Pine Provenance Test

	1	2	3	4	5	6	7	8
1	2006	1960	1903	1961	1995	1949	1987	2002
2	2002	1949	1955	2018	1982	1922	1977	1944
3	1961	1964	1977	1926	2002	1891	2005	1959
4	1939	1957	1891	1985	1999	1950	1959	1939
5	2006	1959	1999	1903	1895	1995	1957	1922
6	1950	1960	2019	2005	1944	2000	1955	2000
7	2000	1913	1987	1995	2006	1985	2019	1977
8	1959	1895	1966	1922	1903	2018	1964	1996
9	1895	1990	1944	1982	1990	1987	1926	
10	1977	1950	1949	1960	1966	1961	1960	
11	1955	1891	1913	2002	1939	1949	1913	
12	1957	1961	1985	1966	1950	1957	1966	
13	1987	1964	1990	1922	1913	1977	2018	
14	1995	2005	1939	1895	1922	2000	1926	
15	2018	1944	2006	1995	1939	1987	2005	
16	1999	1982	1926	1999	1944	1903	1961	→
17	2000	2019	1903	2002	1949	1960	1955	
18				1959	2006	1891	1964	

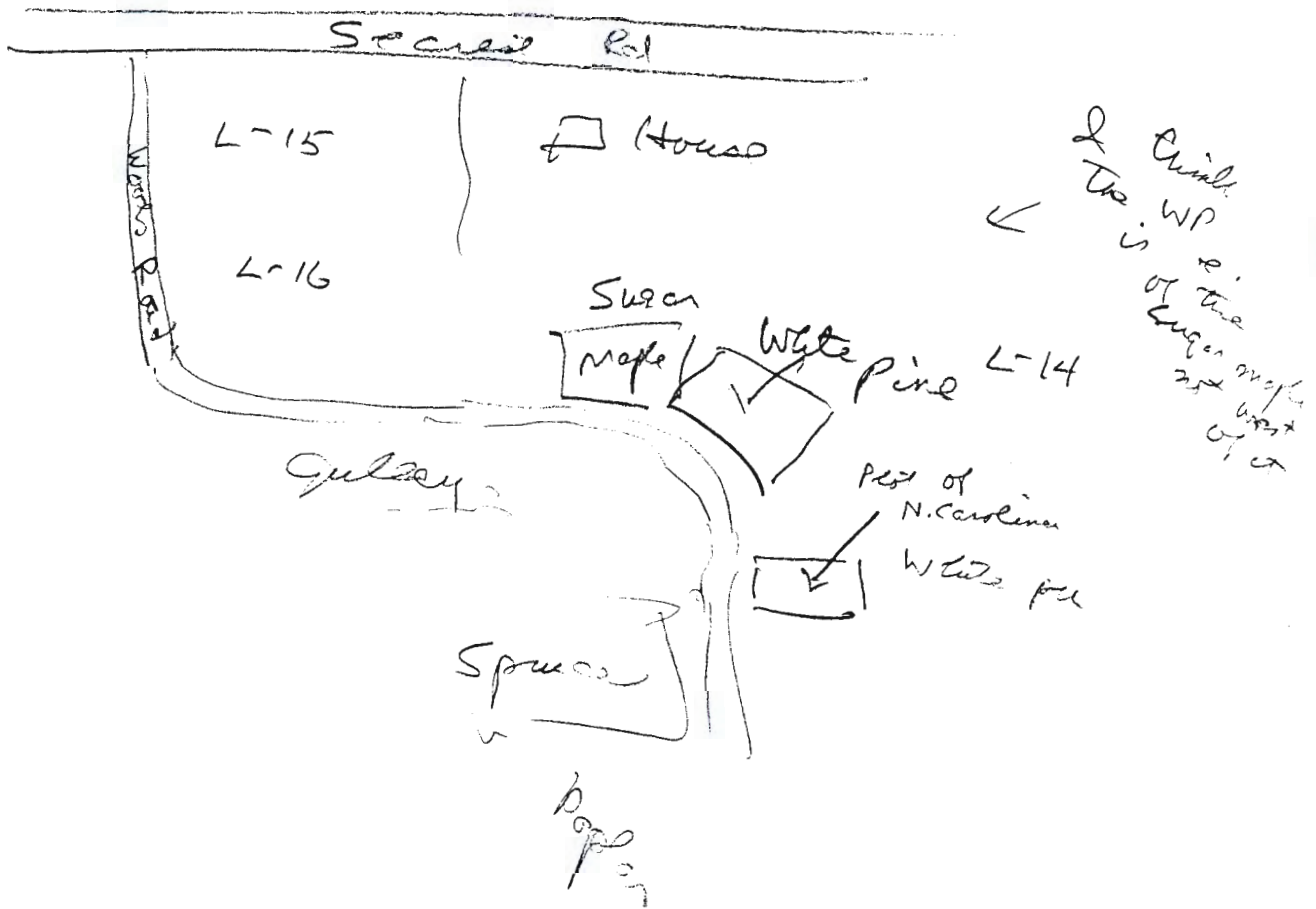

L-14 is a small plot of S. cypriped. White Pine, still there, I think, along the curve of the road going around the gulley from the spruce planting to L-15, L-16, i.e. SE of L-16.

Howard

See map attached

kriebel.1@osu.edu  
262-7650



S. Appalachian White Pine Provenance Test

planted 1968?

ROW  
COLUMN

	1	2	3	4	5	6	7	8
	2006	1960	1903	1961	1995	1949	1987	2002
1	2002 → 1949	1955 → 2018	1982 ← 1922	1977	1944			
2	1961	1964	1977	1926	2002	1891	2005	1959
3	1939	1957	1891	1985	1999	1950	1959	1939
4	2006	1959	1999	1903	1895	1995	1957	1922
5	1950	1960	2019	2005	1944	2000	1955	2000
6	2000	1913	1987	1995	2006	1985	2019	1977
7	1959	1895	1966	1922	1903	2018	1964	1996
8	1895	1990 → 1944	1982	1990	1987	1926		
9	1977	1950	1949 ← 1960	1966	1961	1960		
10	1955	1891	1913	2002	1939	1949 ← 1913		
11	1957	1961	1985	1966	1950 ← 1957 → 1966			
12	1987	1964	1990	1922	1913	1977	2018	
13	1995	2005	1939	1895	1922	2000	1926	
14	2018	1944	2006	1995	1939	1987	2005	
15	1999	1982	1926	1999	1944	1903	1961	
16	2000	2019 ← 1903	2002	1949	1960	1955		
17			1959 ← 2006	1891 ← 1964				

BLOCK 3

BLOCK 1

BLOCK 4

BLOCK 2

alive as of June 1980.

NC-51

L-14 Southern Appalachian White Pine  
Provenance Test

<u>OARDC</u>	<u>MSFGP</u>	<u>Pinus strobus</u>
1891	3431	2018 un 2.
1895	3435	2019 un 3.
1903	3452	30 sources
1913	3478	
1922	3494	
1926	3498	
1939	3511	
1944	3516. (3576)	
1949	3521	NC-51 provenance material
1950	3522	received April, 1968
1955	3527	2-0 seedlings
(1957)	(3529) no survivors	from J. W. Wright
1959	3531	Michigan State University
1960	3532	E. Lansing, Michigan
(1961)	(3533) no survivors	
1964	3537	
1966	3540	
(1977)	(3554) no survivors	
1982	3561	
1985	3564	
1987	3566	
1990	3569	
1995	3574	
1999	3578	
2000	3579	
2002	3581	
2005	3584	
2006	3586	



Marie -

Q1 - Q5 no longer exist. They were south of Dan's yellowpoplar planting and east of the Populus planting (S. of Secret Road).

L-14 is a small plot of S. Cappel, White Pine, still there, I think, along the curve of the road going around the gully from the spruce planting to L-15, L-16, i.e. SE of L-16.

Howard

See map attached

Kriebel, I@osu.edu  
262-7650

Secret Rd

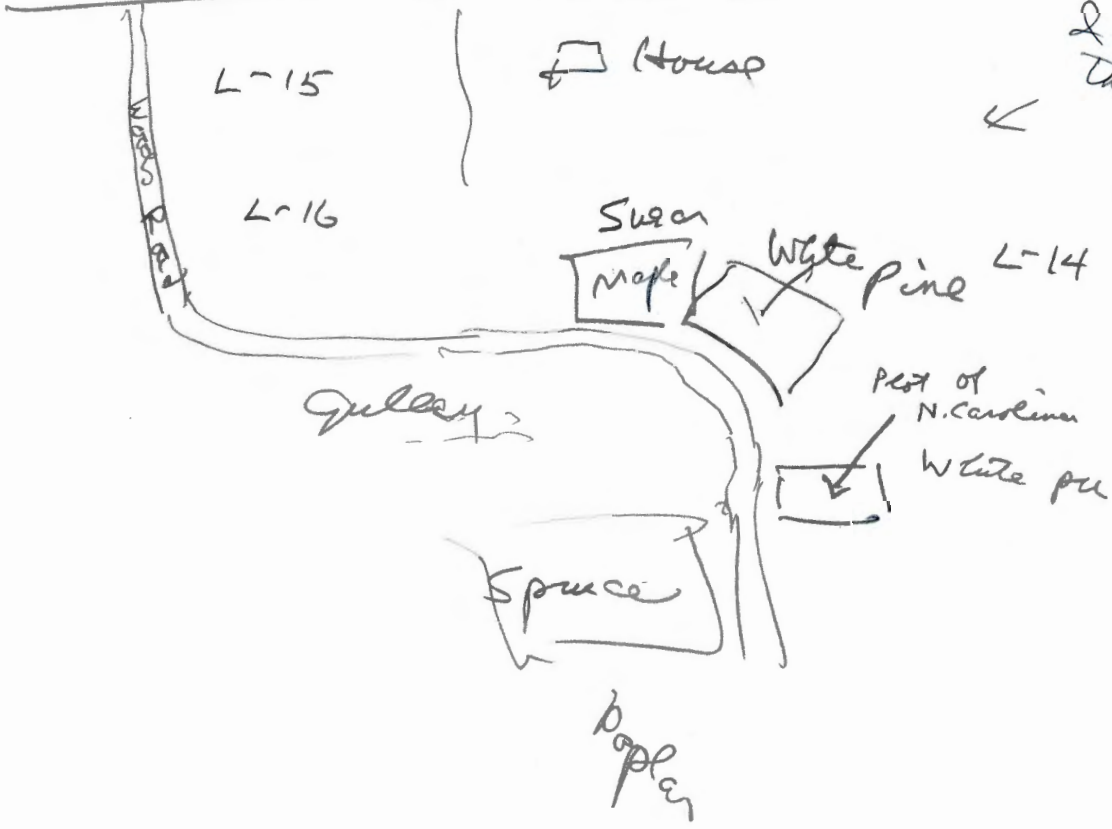

think WP  
is in the  
of Sugar maple  
not west  
of it

part of  
N. Carolina  
White pine

6/10/96

Howard -

Could you give some directions to Marie  
re the location of Q-1-Q-5 (Blue Pine  
Provenance Tests) and L-14 (S. Appl. White  
Pine Provenance Test)?

Thanks,

Dan



S. Appalachian White Pine Provenance Test

ROW  
COLUMN

	1	2	3	4	5	6	7	8
2006	1960	1903	1961	1995	1949	1987	2002	
2002	1949	1955	2018	1982	1922	1977	1944	
1961	1964	1977	1926	2002	1891	2005	1959	
1939	1957	1891	1985	1999	1950	1959	1939	
2006	1959	1999	1903	1895	1995	1957	1922	
1950	1960	2019	2005	1944	2000	1955	2000	
2000	1913	1987	1995	2006	1985	2019	1977	
1959	1895	1966	1922	1903	2018	1964	1996	
1895	1990	1944	1982	1990	1987	1926		
1977	1950	1949	1960	1966	1961	1960		
1955	1891	1913	2002	1939	1949	1913		
1957	1961	1985	1966	1950	1957	1966		
1987	1964	1990	1922	1913	1977	2018		
1995	2005	1939	1895	1922	2000	1926		
2018	1944	2006	1995	1939	1987	2005		
1999	1982	1926	1999	1944	1903	1961	→	
2000	2019	1903	2002	1949	1960	1955		
			1959	2006	1891	1964		

## Southern Appalachian White Pine Provenance Test

Block	Row	Column	Source	1	2	
01	7	1	1977	-	-	
	↓	2	2005	375		
		3	1959	-	-	
		4	1957	-	-	
		5	1955	436		
		6	2019	-	-	
		7	1964	-	-	
		8	1926	-	-	
		9	1960	-	-	
		10	1913	466*		
6	10	1949	-	-		
	9	1961	-	-		
	8	1987	466			
	7	2018	-	-		
	6	1985	6011			
	5	2000	-	-		
	4	1995	639			
	3	1950	-	-		
	2	1891	-	-		
	1	1922	-	-		
5	1	1982	6411			
	2	2002	-	-		
	3	1999	-	-		
	4	1895	6811			
	5	1944	6913			
	6	2006	6811			
	7	1903	-	-		
	8	1990	6112			
	9	1966	6311			
	10	1939	6412			
02	7	11	1966	-	-	
	↓	12	2018	-	-	
		13	1926	-	-	
		14	2005	-	-	
		15	1961	-	-	
		16	1955	488		
		17	1964	479		
6	17	1891	5612			



Block	Row	Column	Source	1	2
02	6	16	1980	62	10
	↓	5	1903	59	12
		14	1987	35	4
		13	2000	51	9
		12	1977	-	-
		11	1957	-	-
5	11	1950	-	-	-
		12	1913	-	-
		13	1922	-	-
		14	1939	66	11
		15	1944	-	-
		16	1949	67	10
	→	17	2006	53	8
4	17	1959	57	9	
		16	2002	69	13
		15	1999	71	12
		14	1995	64	10
		13	1985	-	-
04	4	12	1922	-	-
	↓	11	1966	-	-
		10	2002	53	9
		9	1960	71	11
3	9	1949	61	12	
		10	1913	-	-
		11	1985	-	-
		12	1990	44	4
		13	1939	77	14
		14	2006	-	-
		15	1926	74	16
		16	1903	-	-
2	16	2019	54	8	
		15	1982	48	5
		14	1944	76	12
		13	2005	-	-
		12	1964	80	14
		11	1961	-	-
		10	1891	-	-
		9	1950	71	12



Block	Row	Column	Source	1	2	
041 ↓	7	1959	41	4		
	8	1895	66	10		
	9	1977	-	-		
	10	1955	-	-		
	11	1957	-	-		
	12	1987	-	-		
	13	1995	56	9		
	14	2018	-	-		
	15	1999	-	-		
	16	2000	36	4		
3	1	6 2000	67	10		
	5	1950	-	-		
	4	2006	70	13		
	3	1939	83	12		
	2	1961	-	-		
	1	2002	-	-		
	2	1	1949	84	12	
	2	1964	-	-		
	3	1957	-	-		
	4	1959	-	-		
	5	1960	89	15		
	6	1913	75	11		
	7	1895	80	15		
	8	1990	76	14		
	3	8	1944	80	14	
	7	1966	85	15		
6	1987	44	4			
5	2019	68	9*			
4	1999	83	13*			
3	1891	-	-			
2	1977	-	-			
1	1955	-	-			
4	1	2018	75	12*		
2	1926	-	-			
3	1985	87	13			
4	1903	-	-			
5	2005	66	12			
6	1995	90	11			

Block	Row	Column	Source	1	2
03	4	7	1722	60	9
↓		8	1982	33	5

- 
1. Height to nearest 0.1 meter x 10 6/24/80
  2. Diameter at breast height to nearest centimeter 6/24/80



Source means : heights in meters and D.B.H. in centimeters

Map # (Source)	height in meters	D.B.H. in centimeters	# of trees averaged			Ranking (H4)				
1891	5.60	12.0	1	NC	Bur. 31	16				
1895	7.13	12.0	3	NC	Bur 35	6				
1903	5.90	12.0	1	NC	Gr 52	15				
1913	6.05	8.5	2	WV	Poc 78	12				
1922	6.00	9.0	1	TE	Po 94	14				
1926	7.40	16.0	1	TE	Po 98	2				
1939	7.25	12.2	4	TE	Mo <sup>35</sup> 11	4				
1944	7.30	12.2	3	WV	We <sup>35</sup> 76	3				
1949	6.59	12.0	3	GA	Fa 3521	8				
1950	7.10	12.0	1	NC	Ch 3522	7				
1955	4.55	7.0	2	NC	ch 3527	21				
1957	—	—	—	—	—					
1959	4.90	6.5	2	NC	Ch 3531	19				
1960	7.40	12.0	3	TE	An 3532	2				
1961	—	—	—	—	—					
1964	6.35	11.5	2	TE	An 3537	9				
1966	7.40	13.0	2	TE	An 3540	2				
1977	—	—	—	—	—					
1982	4.83	7.0	3	WV	Pf 3561	20				
1985	7.17	11.7	3	WV	Gr 3564	5				
1987	4.17	4.7	3	WV	Gr 3566	22				
1990	6.03	10.0	3	WV	Gr 3569	13				
1995	6.32	9.5	4	WV	We 3574	10				
1999	7.70	12.5	2	WV	We 3578	1				
2000	5.13	7.7	3	WV	We 3579	18				
2002	6.10	11.0	2	WV	Br 3581	11				
2005	5.15	8.5	2	WV	Br 3584	17				
2006	6.05	9.5	2	WV	Br 3586	12				
2018	7.50	12.0	1	und.	MSFC					
2019	6.10	8.0	2	und.	MSFC					



Secret rd.

Row

Col.	1	2	3	4	5	6	7
1	1939	2018	1955	2006	1887	1959	1921
2	1966	1891	1950	1996	1942	1999	1949
3	1903	1890	1985	1944	1922	1968	2019
4	1957	2005	1926	1977	2000	1956	1995
5	1982	2002	1990	1987	1904	1961	1895
6	<u>1960</u>	<u>1994</u>	<u>1881</u>	<u>1964</u>	<u>1913</u>	<u>2008</u>	<u>1890</u>
7	1982	1881	2005	1904	1961	1990	1939
8							
9							
10							
11							
12							
13							
14							
15							
16							
17							
18							
19							
20							
21							
22							
23							
24							
25							

2 - 14 ?

31  
4  
124

- 4 (✓) 2006 10
- (✓) 2000 6
- (✓) 2002 8
- (✓) 2005 5
- (✓) 1987 6
- (✓) 1961 11
- (✓) 1960 8
- (✓) 1959 12
- (✓) 1955 5
- (✓) 1944 9
- (✓) 1939 10
- (✓) 1922 6
- (✓) 1903 13
- (✓) 1895 4
- (✓) 1891 4
- (✓) 1987 6
- ✓ 1995 6
- ~~1996 5~~
- ✓ 1999 5
- (✓) 1964 4
- (✓) 1913 5
- (✓) 1926 5
- (✓) 1949 9
- (✓) 1950 5
- (✓) 1966 5
- (✓) 1977 6
- ✓ 1985 3

- (✓) 1982 3
- (✓) 1957 5
- (✓) 2018 5
- (✓) 2019 3
- ✓ 1990 3

○ = not in M-1



# ACCOPRESS®

NO. 2507

BF-RED	BL-GOLD
BG-BLACK	BQ-PALM GREEN
BD-LT. GREY	BX-EXECUTIVE RED
BP-LT. GREEN	BR-BROWN
BU-LT. BLUE	BA-TANGERINE
BY-YELLOW	BB-ROYAL BLUE
SPECIFY NO. & COLOR CODE	

ACCO DIVISION OF GARY INDUSTRIES, INC.  
CHICAGO, ILLINOIS 60630



