

Walker House

Herrick Archives Number 040

A. IDENTIFICATION & LOCATION

1. Name

1.1 Officially named the "Grace Graham Walker House" by Board of Trustees on May 9, 1932.

1.2 Alternate names noted:

Home Management House
Practice House for Home Economics
Practice Rouse on 11th Avenue
Practice Hall on 11th Avenue
Women's Self Government Association House

See Addenda Nos. 1, 2, 3

2. Location

2.1 Located at 220-222 West 11th Avenue. See map, below.

2.2 For greater detail, see Sheet 110 in the book of campus maps in the university Archives.

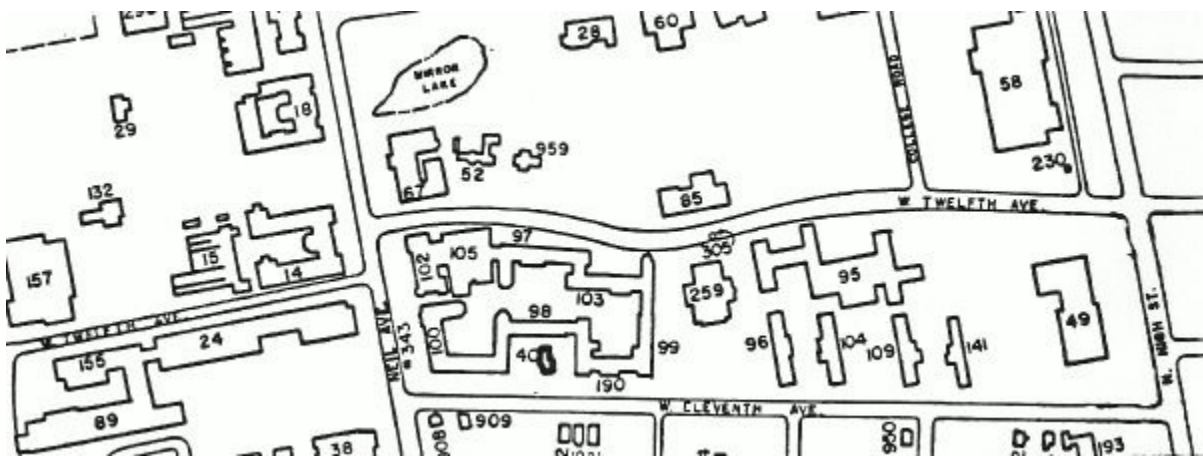

For identification of other buildings shown. See Appendix A.

3. General Description

3.1 Type of construction:

Wood frame with brick and exposed timber exterior

3.2 No. of stories

Basement plus 3 stories

3.3 Increments of construction:

No additions

3.4 Present area of building as shown in inventory records of Division of Campus Planning

6,229 sq. ft. gross;
3,915 sq. ft. net assignable

See Addendum No. 4

3.5 Volume of building:

65,000 cu. ft. (PP)

B. PLANNING & CONSTRUCTION

1. On July 15, 1930 the Board of Trustees approved the plans and related documents prepared by Howard Dwight Smith and authorized the solicitation of bids by contractors.
2. Bids were received on September 5, 1930 (T). Since bids were too high, certain revisions were made and new bids were received November 7, 1930 (T).
3. On November 15, 1930 the Board of Trustees approved Cabinet action awarding contracts to the following contractors:

General: Herman C. Weller
Heating and Plumbing: Northside Plumbing Co.
Note: Electrical work was included in the general contract (A).

4. Completion and occupancy:

Date of final occupancy not definitely established. The building was expected to be ready for Autumn Quarter 1931 (R 30-31:6), and probably was. Cabinet authorized the installation of walks on September 3, 1931 and of the gas line on September 24, 1931. Final estimates in the University Architect's files are dated September 25, 1931 for the heating and plumbing contractor and October 12, 1931 for the general contractor.

C. PHOTOGRAPHS

In Photoarchives:

X 7612
X 20637
X 7764
X 7765

D. MISCELLANEOUS

This structure is divided into two separate units or houses by interior design, and operates as two separate practice houses. The southerly half, at 220 West 11th, was usually know as "Home Management House East" and "Home Management House South". The other half, at 222 West 11th, was known as "Home Management House West" and possibly as "Home Management House North".

John H. Herrick
December 1, 1976

See Addendum No. 2

ADDENDUM No. 1

This building was assigned to the office of Residence and Dining Halls in September 1975 for use by the Women's Self Government Association. Since that time it has been used as the Ann Tweedale scholarship house, which formerly used rented space off campus.

John H. Herrick
December 2, 1976

ADDENDUM No. 2

Old Campus Planning records refer to "Home Management Houses 1 and 2". According to Dorothy Scott, Professor Emeritus and former Director of the School of Home Economics, No. 1 was at 220 West Eleventh Avenue and No. 2 was at 222 West Eleventh Avenue.

John H. Herrick
July 20, 1979

ADDENDUM No. 3

Inspection of old campus maps reveals the following additional names for this building:

Home Economics Residence
Walker Home Management House

John H. Herrick
December 21, 1979

ADDENDUM No. 4

Campus Planning records new show the net assignable area of this building as 3,939 square feet.

John H. Herrick
November 7, 1984

ADDENDUM No. 5 - Renaming 220-222 W. 11th Ave.

July 12, 1991, The Board of Trustees resolved that 220-222 W. 11th Ave should be called "Alumnae Scholarship House" to reflect that the Alumnae Scholarship Housing Program resides there.