

# Storm Lift Station

## Herrick Archives Building S 43

This is a reinforced concrete building in the edge of the levee west of Lincoln Tower (Building 271). See sketch below. It appears on Sheet 94 in the book of campus maps in the University Archives.

See Addendum No. 1

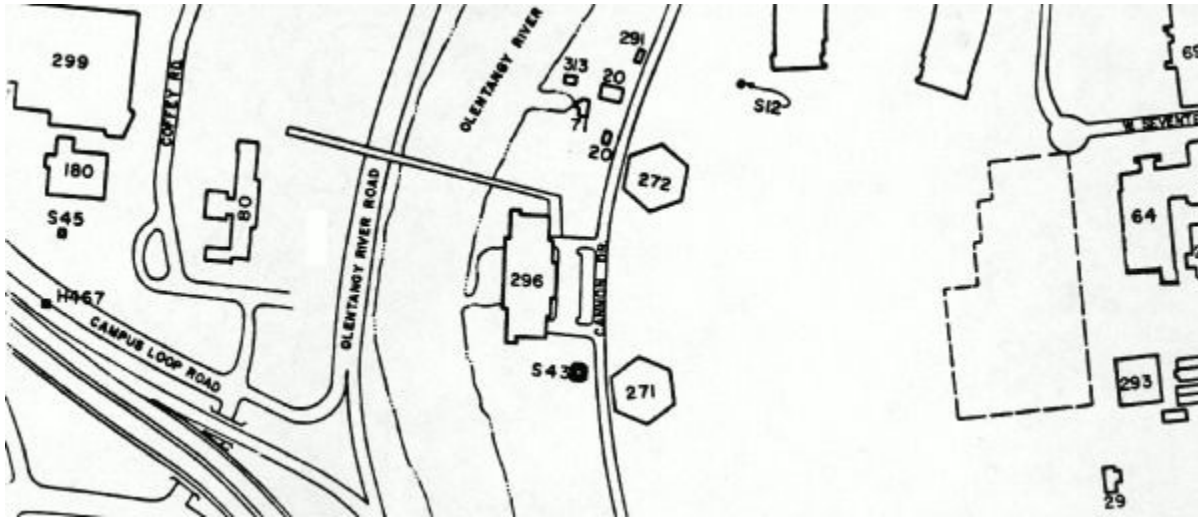

For identification of other buildings shown, see Appendix A.

Small scale maps indicate a size of approximately 15' square.

The purpose of the building is to house equipment for pumping flood water across the levee into the river.

For picture see X 12051 and X 12051 in Photoarchives.

John H. Herrick

March 12, 1975

### ADDENDUM NO. 1

Address arbitrarily assigned for indexing purposes: 1813 Cannon Drive.

John H. Herrick

February 17, 1976